

RC-8D – Desktop Radio Controller

Product Dismantling and Recycling

Part Number: 104694, 104695

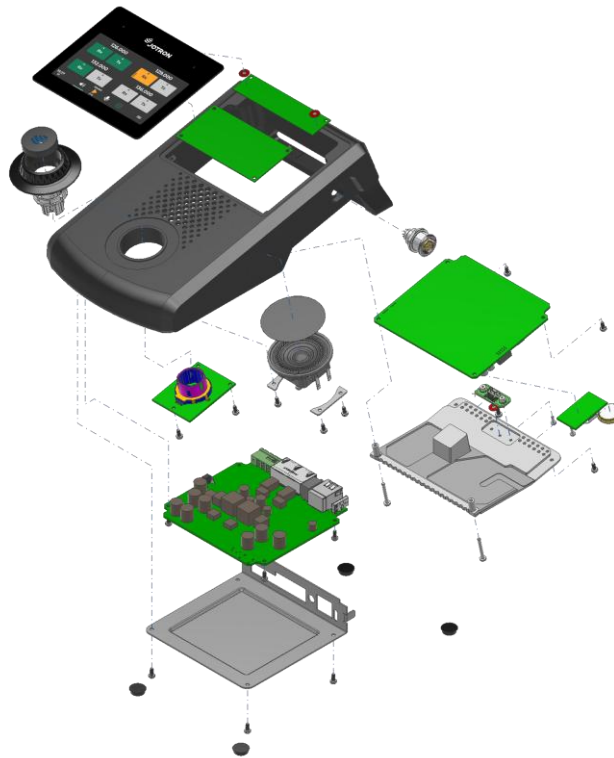

- 1) Remove the scroll/select knob
- 2) Remove the screws from the bottom cover
- 3) Disassemble the radio controller unit and separate metals and printed circuit boards

RC-8D – Desktop Radio Controller

Product Dismantling and Recycling

Part Number: 104694, 104695



MECHANICAL /HOUSING



ELECTRONICS



BATTERY

<p>The mechanical housing for the radio controller is made of Aluminum which is 100% recyclable</p>	<p>There are 5 boards in the radio controller unit that contain electronic components:</p> <ul style="list-style-type: none">- Processor & Display board- Connector and Power supply board- Encoder board- Microphone and Bluetooth board- Display adapter board <p>Some of the boards may contain critical materials which should be recycled</p>	<p>No batteries in the unit</p>
---	---	---------------------------------

PROPER PRODUCT DISPOSAL AND RECYCLING

For proper product disposal and recycling, please:

- Consult your local authorities about your country's disposal and recycling rules and regulations.
- Observe the applicable WEEE (Waste from Electrical and Electronic Equipment) rules.
- Refer to the table on the next page for details regarding critical raw materials in various components.

RC-8D – Desktop Radio Controller

Product Dismantling and Recycling

Part Number: 104694, 104695

Critical raw materials (CRMs) are of high economic importance and have a high risk of supply chain disruption. In 2023, EU published a fifth list of 34 CRMs in the Annex II of [the Regulation proposal COM\(2023\)](#) based on the [Study on the Critical Raw Materials for the EU 2023 – Final Report](#).

Based on the fifth list 2023 of critical raw materials for the EU, Jotron has conducted an analysis of CRM content in the company's products. The content is limited to information sourced by responses and documentation from suppliers and manufacturers. The sourcing of documentation was done by questions on email, phone calls, meetings and searching verified online pages. The CRM content is limited to commodity group, not part specific.

The table below lists Jotron's commodity types that may contain critical raw materials (CRMs).

Capacitor	Connector	Diode	Fasteners	Fuse
Aluminium (bauxite) Copper	Brass (copper) Nickel	Copper Silicon	NA	Aluminium (bauxite) Copper Nickel
Inductive parts	Integrated circuit	Memory	Metal sheet	Opto
Magnesium Titanium dioxide	Aluminium (bauxite) Copper	Aluminium (bauxite) Baron Copper	Aluminium (bauxite) Copper Nickel	Fluorine Possible terbium* in display
Printed circuit boards	Relay	Resistor	Switchers	Batteries
Copper	Aluminium (bauxite) Copper Nickel	Aluminium (bauxite) Bismuth Boron Nickel Silicon Titanate (titanium)	Aluminium (bauxite) Copper Manganese Nickel Silicon	Aluminium Cobolt Copper Gallium Lithium Manganese Nickel

*heavy rare earth element