

# Quick start MANUAL

## TronTracker RA10 Receiver

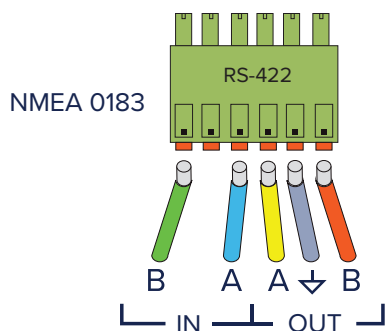

### 2 Connections

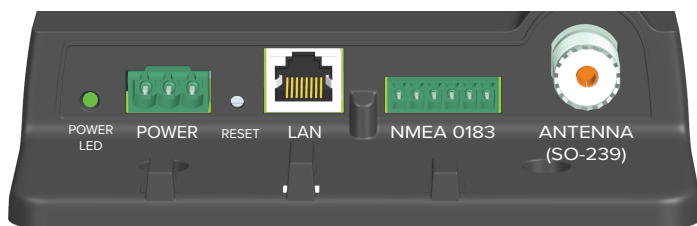

To connect to an electronic chart system, use the supplemented NMEA 0183 connector. IN and OUT in the figure is as seen from the RA10 Receiver.

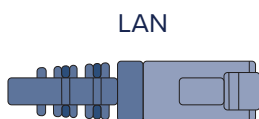

LAN can be used as an alternative to serial port for communication with electronic chart systems.

### 1 Installation

The Receiver shall be mounted vertically, with the connectors pointing downward, and secured using three screws. It must be mounted in a location that is protected from water splashes.

Use screws that are suitable for the mounting surface. The hole diameter on the receiver is 4.8 mm.

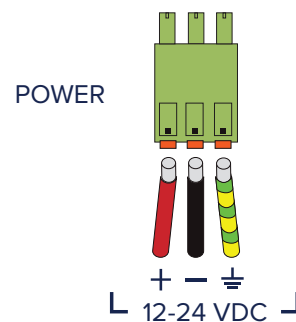
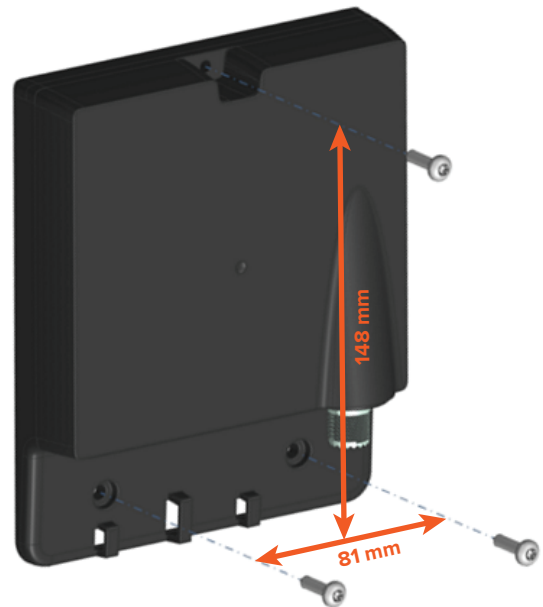

The Receiver shall be powered by a 12–24 V DC supply. Once connected, the green indicator light on the left side of the power connector will light up.



The antenna should be installed in the same manner as a VHF-radio installation. Use a low-loss cable if the length is over 10 meters (RG-213 or better). An antenna gain between 0 and +3 dBd is recommended. The receiver has an SO-239 connector that is to be connected with a PL-259 connector.



#### Important!

Make sure the antenna cable is tightly fastened to the Receiver. A firm connection is critical for the signal reception.

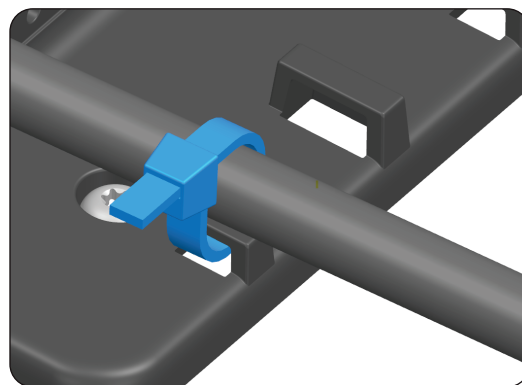
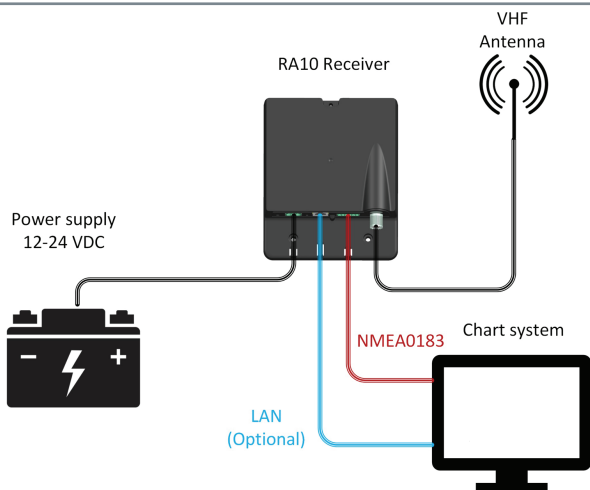

Secure the cables to the housing using cable ties.

### 3 App installation



Apple - App Store

Download the Jotron TronTracker mobile app from App Store or Google Play.



Android - Google Play

### 4 First-time setup

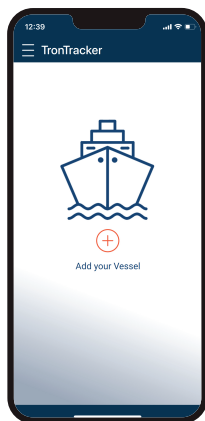

1. Add your vessel in the app. This allows your Receiver and Trackers to be correctly linked and organized.

Tap **'Add your Vessel'** on the screen and enter your vessel's name and MMSI number.

**Note:** If you manage more than one vessel, you can repeat this step for each.

2. After adding your vessel, tap **'Add Device'** to find your Receiver via Bluetooth. Bluetooth is always activated on the Receiver.

The devices will appear in the list under **'Adding Device'**.

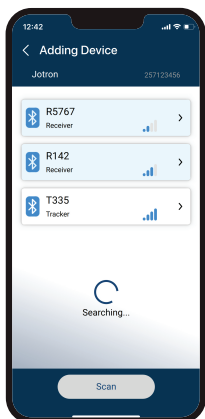
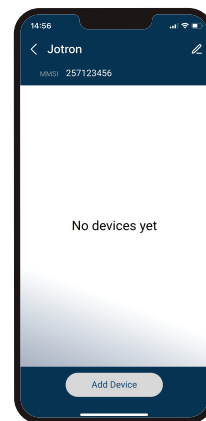

3. When the desired device is selected, you'll be prompted to enter a PIN code. This code is unique to each device and can be found on a label on your product.

Click **'Add to Vessel'** to add the Receiver to your list of devices.

Use the app to configure your Receiver according to your installation. For more information, refer to the app.



Translated manuals:



jotron.com

For more information, please download the installation manual from [jotron.com](http://jotron.com).