

Tron TR 8000 series Transponder unit

Product Dismantling and Recycling

Part Number: 85300

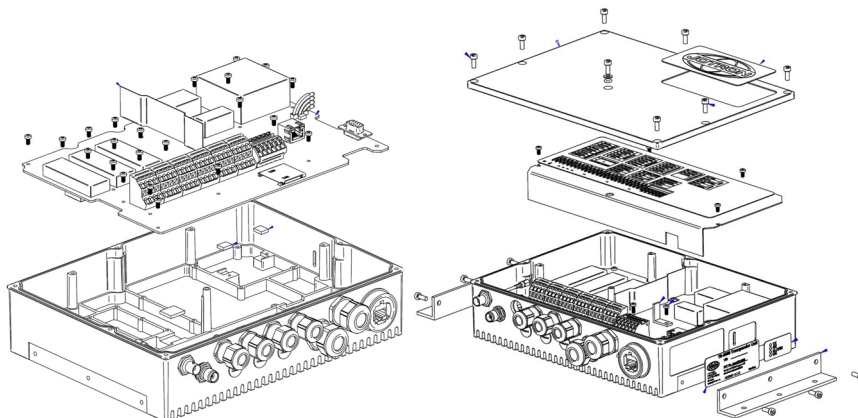

- 1) Tools are required to disassemble the Tron TR 8000 Transponder unit.
- 2) The Transponder unit mainly consists of mechanical parts and an electronic circuit board.
- 3) Disassemble the Transponder unit as described in the drawings above and separate the parts accordingly.

Tron TR 8000 series Transponder unit

Product Dismantling and Recycling

Part Number: 85300



MECHANICAL / HOUSING



ELECTRONICS



BATTERY

The mechanical housing on the TR 8000 Transponder unit mainly consists of mechanical parts like aluminum and various stainless-steel screws.

The Transponder unit consists of a printed circuit board. Some of the components may contain critical raw materials.

The TR 8000 Transponder unit does not consist of batteries.

PROPER PRODUCT RECYCLING

For proper product disposal and recycling, please:

- Consult your local authorities about your country's disposal and recycling rules and regulations.
- Observe the applicable WEEE (Waste from Electrical and Electronic Equipment) rules.

Tron TR 8000 series Transponder unit

Product Dismantling and Recycling

Part Number: 85300

CRITICAL RAW MATERIAL (CRM) CONTENT PER COMMODITY TYPE

Critical raw materials (CRMs) are of high economic importance and have a high risk of supply chain disruption. In 2023, EU published a fifth list of 34 CRMs in the Annex II of [the Regulation proposal COM\(2023\)](#) based on the [Study on the Critical Raw Materials for the EU 2023 – Final Report](#).

Based on the fifth list from 2023 of critical raw materials for the EU, Jotron has conducted an analysis of CRM content in the company's products. The content is limited to information sourced by responses and documentation from suppliers and manufacturers. The sourcing of documentation was done by questions on email, phone calls, meetings and searching verified online pages. The CRM content is limited to commodity group, not part specific.

The table below lists Jotron's commodity types that may contain critical raw materials (CRMs).

Capacitor	Connector	Diode	Fasteners	Fuse
Aluminium (bauxite) Copper	Brass (copper) Nickel	Copper Silicon	NA	Aluminium (bauxite) Copper Nickel
Inductive parts	Integrated circuit	Memory	Metal sheet	Opto
Magnesium Titanium dioxide	Aluminium (bauxite) Copper	Aluminium (bauxite) Baron Copper	Aluminium (bauxite) Copper Nickel	Fluorine Possible terbium* in display
Printed circuit boards	Relay	Resistor	Switchers	Batteries
Copper	Aluminium (bauxite) Copper Nickel	Aluminium (bauxite) Bismuth Boron Nickel Silicon Titanate (titanium)	Aluminium (bauxite) Copper Manganese Nickel Silicon	Aluminium Cobolt Copper Gallium Lithium Manganese Nickel

*heavy rare earth element